

heat trace cable End junction box is also called the terminal head, which is used at the end of the electric heating cable to isolate the electric heating cable from the outside world. "Exell CT4" is suitable for all-weather conditions and the use of explosive gas mixtures in the first and second zones of petrochemical plants in Group T4. The structure is tight, and the sealing effect is much better than the ordinary simple tape at the end, and the service life is long, and it is not afraid of bad weather such as rain and snow.

heat trace cable End junction box use and install

3.22 尾端密封接线盒

Tail sealed wiring

简介Brief introduction

它是用于自控温伴热电缆的尾端密封接线盒。伴热线端正部安装所需材料均可放于：尾端严禁绞合

It is applied for self-regulating heating cable -which is fixed on pipe during installing,with an insulation layer out.All of the materials used for heating wire insulation could be placed in box.

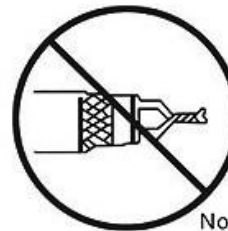
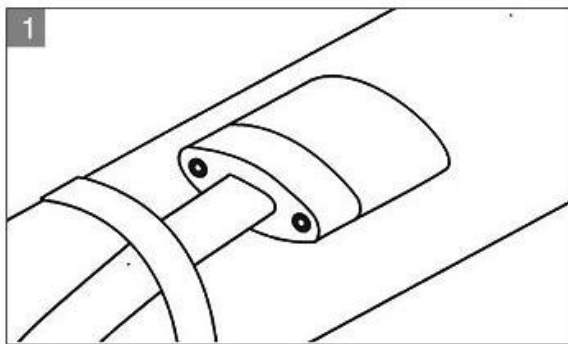

注：尾端严禁绞合
Notice non-twisting in tail

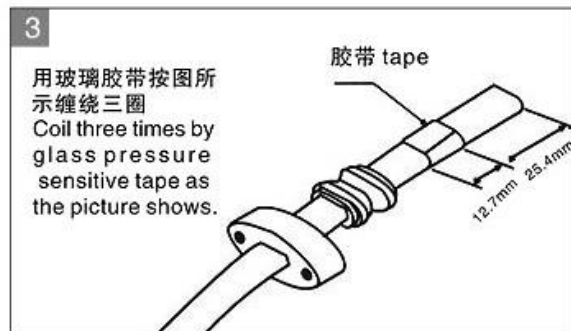
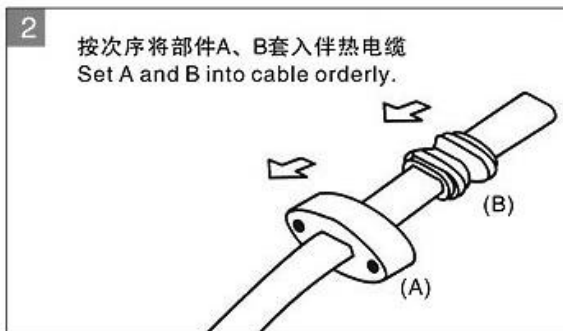

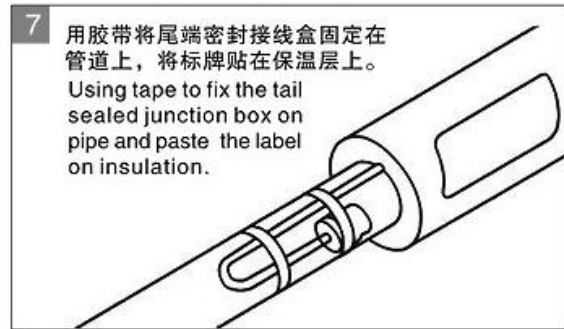
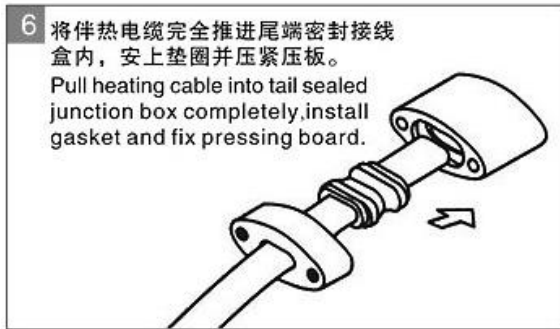
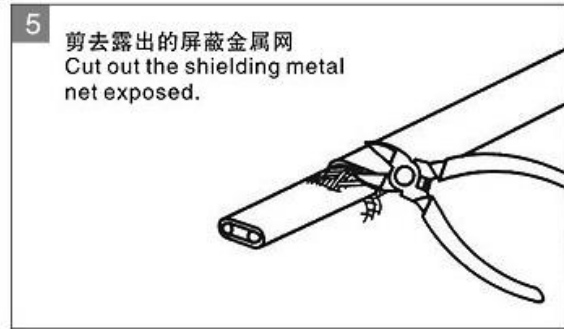
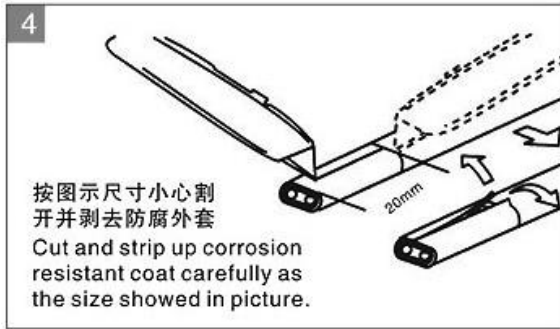

When the pipe length is not more than 100 meters and there is no branch pipe, the installation of the electric heating cable is very simple. You only need to use the [heat trace cable power junction box](#) and the end junction box, then fix the heating cable, the power junction box and the end junction box, and finally Laying insulation materials, such a simple set of pipeline heat tracing insulation system is completed, and it can play a role when it is powered on.